

EROWA FTS

Good things come in
small packages

Integration

Automation

Organization

Standardization

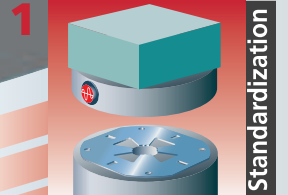

For workpiece palletization on small machines



EROWA®
System solutions
from one single source

EROWA FTS - great precision, low height

The importance of setting up while the machine is in operation does not depend on the size of the workpieces. Rather, it is the work involved in changing from one production batch to another that has a crucial impact on the productivity of the machines. Setting up outside the machine can therefore also be a substantial manufacturing success factor with very small parts, on machines that have been designed for fine and finest machining processes.

EROWA's FTS Fine Tooling System has been specially adapted to such requirements. With its positioning accuracy of less than 0.002mm and with its extremely flat design, it contributes towards an optimal use of the machining range of small machines.

Function

Precision pallet

In order to squeeze the very last thousandth of a millimeter out of the system, the pallet has been manufactured from one piece. This high-precision manufacture pays off in terms of an extremely good positioning accuracy.

Centering

Both the centering process and the clamping process are achieved by means of special profiles. Thanks to the low height of the pallet, only a clearance of 4mm is required to separate the pallet from the chuck.

Locking mechanism

The locking and centering mechanism - for which a patent is pending - is powered by spring tension. This means that functional safety is also guaranteed in case of a pressure failure.

Air supply

The pneumatic chuck is controlled through the lateral connections or directly through the base plate. The opening cycle and the automatic cleaning process of the support surfaces is controlled by means of compressed air.

Central duct

Despite the chuck's small dimensions, there is still sufficient space for compressed-air, vacuum or hydraulic lines to be led to the pallet. In this way, the fixtures can also be operated automatically, for instance on transfer machines with frequently changing production batches.

Seal

The well-thought-out seal ensures that clamping and positioning remain clean and precise even under aggravated conditions. The FTS is corrosion-resistant. It can also be used for WEDM.



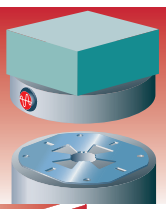

Little space on the machine?

Moderate machining forces?

Great demands on precision?

If the answers are yes, then have a closer look at EROWA FTS Fine Tooling System. All the components are made of stainless steel. The chucks can be fitted to a wide variety of machine tables, either directly or with adapter plates. A standard pallet covers the main operational possibilities. And we'll gladly assist you with ideas and concepts for fixtures that will satisfy your very special wishes.

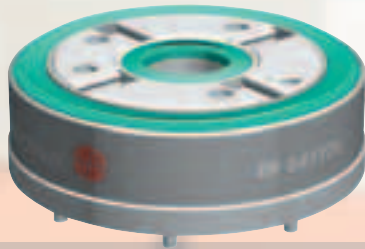

The chuck's low height of 23mm makes it suitable for use on machines with small machining ranges.



A clearance of only 4mm is needed to lift the pallet off the chuck. This saves space in the Z-axis! The total height to the top edge of the pallet is just below 30mm.

Technical data

	FTS Fine Tooling System
Repeatability	< 0.002 mm
Indexation	4 x 90°
Clamping power	400 N
Recommended workpiece size	depends on machining forces
Clamping process	spring tension
Opening	compressed air, min. 6bar
Operation	control unit or air gun

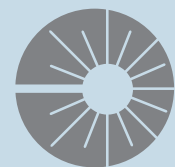

ER-047776 FTS chuck, manual



Version Pneumatic FTS chuck, corrosion-resistant.
To fit With M3x7 bolts through the chuck.
Connections Lateral for opening.
Operation With manual valve ER-010538.

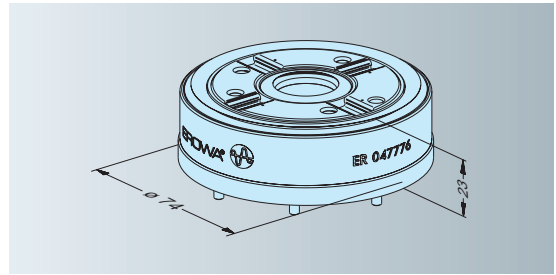

ER-047777 FTS chuck, pneumatic



Version Pneumatic FTS chuck, corrosion-resistant.
To fit With M3x7 bolts through the chuck.
Connections At the rear for opening and cleaning/monitoring.
Operation With manual control unit ER-008988.

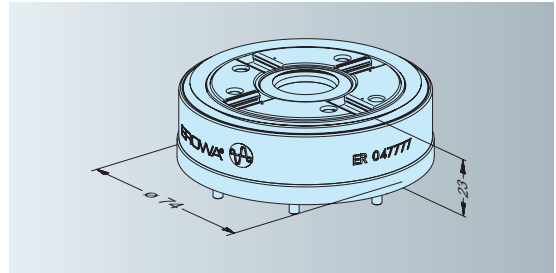

ER-047429 FTS chuck with base plate



Version Pneumatic FTS chuck with base plate, corrosion-resistant.
To fit With M3x4 bolts on grid dimension 63mm through the base plate.
Connections Lateral for opening and cleaning/monitoring.
Operation With manual control unit ER-008988.

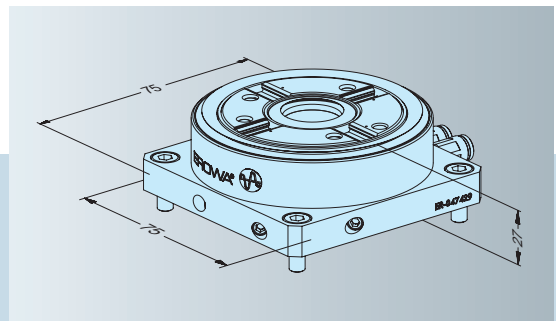

ER-042223 FTS pallet



Version Steel pallet, hardened, including positioning pin for safe positioning. With central borehole \varnothing 18mm.
Application To accommodate workpieces or fixtures.
To fit blanks Through the pallet with M3x4 bolts.

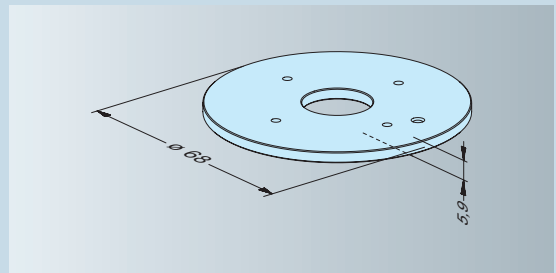

ER-045285 FTS cover



Version Aluminum, with elox finish.
Application To protect chucks that are not in operation on the machine.
Note CANNOT be used as a pallet.

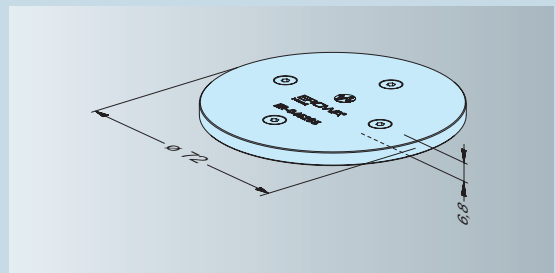

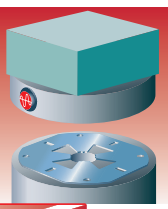

ER-044023 FTS alignment pallet

INOX



- Version** Steel, corrosion-resistant, hardened and ground.
- Application** To align and check the chuck position on the machine.
- Note** All the axes – X, Y and Z – as well as the center are checked with the same alignment pallet.

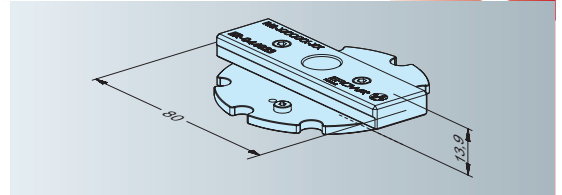

Take the next step.

Important matters require planning. And your next step is certain to be an important decision advancing your company even further. We will gladly support you during every step. You can profit from our advice and practical experience in today's modern and flexible manufacturing concepts.

Take that important next step. Contact an EROWA agency near you.

EROWA AG 049836 e/04.06

USA

EROWA Technology, Inc.
North American Headquarters
2535 South Clearbrook Drive
Arlington Heights, IL 60005
Tel. 847 290 0295, Fax 847 290 0298
e-mail: info@erowatech.com

Germany

EROWA System Technologien GmbH
Gewerbepark Schwadernmühle
Rossendorferstrasse 1
D-90556 Cadolzburg b. Nbg.
Tel. 09103 7900-0, Fax 09103 7900-10
e-mail: info@erowa.de

Singapore

EROWA South East Asia Pte. Ltd.
20 Loyang Street
Loyang Industrial Estate
Singapore 508849
Singapore
Tel. 6542 02 38, Fax 6542 03 47
e-mail: sales.singapore@erowa.com

Japan

EROWA Nippon Ltd.
Shiba Shimizu Bldg.
2-3-11 Shiba Daimon, Minato-ku
105-0012 Tokyo
Tel. 03 3437 0331, Fax 03 3437 0353
e-mail: info@erowa.co.jp
www.erowa.co.jp

Switzerland

EROWA AG
Knutwilerstrasse 3
CH-6233 Bürön
Tel. 041 935 11 11, Fax 041 935 12 13
e-mail: info@erowa.com
www.erowa.com

Spain

EROWA Technology Ibérica S.L.
Enamorados, 103. Local 5
E-08026 Barcelona
Tel. 093 265 51 77, Fax 093 244 03 14
e-mail: erowa.info@facilnet.es

Eastern Europe

EROWA TECHNOLOGY Sp. z o.o.
ul. Solskiego 44
52-416 Wrocław / Poland
Tel. 071 363 56 50
Fax 071 363 49 70
e-mail: europe-east@erowa.com
www.erowa.com

Sweden

EROWA Nordic AB
Salagatan 24
S-16353 Spånga
Tel. 08 36 42 10, Fax 08 36 53 91
e-mail: info@erowa.se

Italy

EROWA Tecnologie S.r.l.
S.S. 24 km 16,200
10091 Alpignano (TO)
Tel. 011 9664873, Fax 011 9664875
e-mail: info@erowa.it

France

EROWA Distribution France Sàrl
PAE Les Glaisins
12, rue du Bulloz
F-74940 Annecy-le-Vieux
Tel. 4 50 64 03 96, Fax 4 50 64 03 49
e-mail: info@erowa.tm.fr

China

SHANGHAI HANOWA LTD.
Precision Mechanics Engineering
G/F, No. 24 Factory Building House
69, Gui Qing Road
200233 Shanghai
Tel. 021 6485 5028, Fax 021 6485 0119
e-mail: hanowa@online.sh.cn