

F-Tool flexible 5-side machining

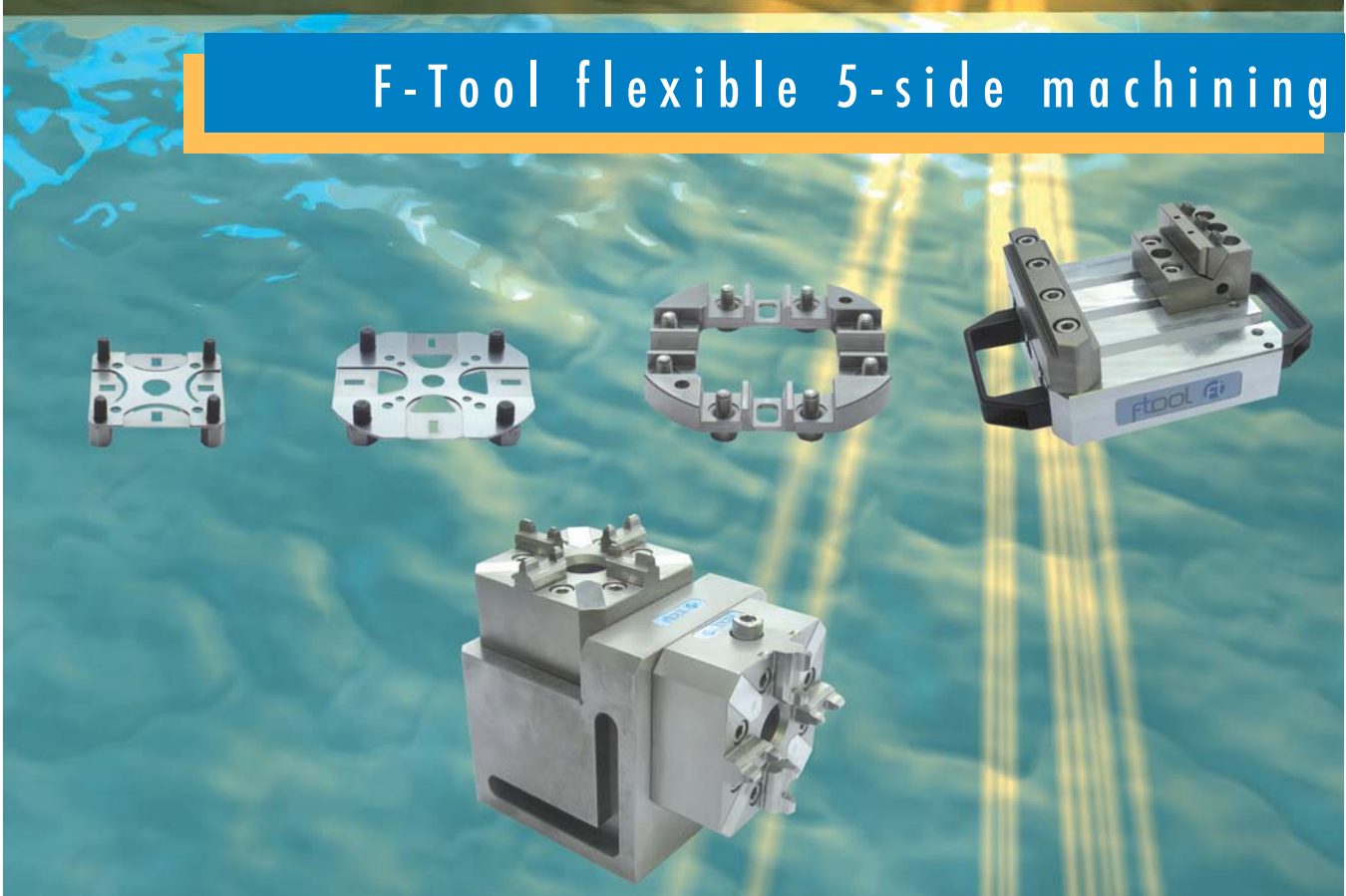

- Flexible machining of cubic pieces of miscellaneous sizes
- Accurate, strong and centrally clamping simplifies the machining
- Time saving and quality intensification profits the investment within less than a year

Sample applications

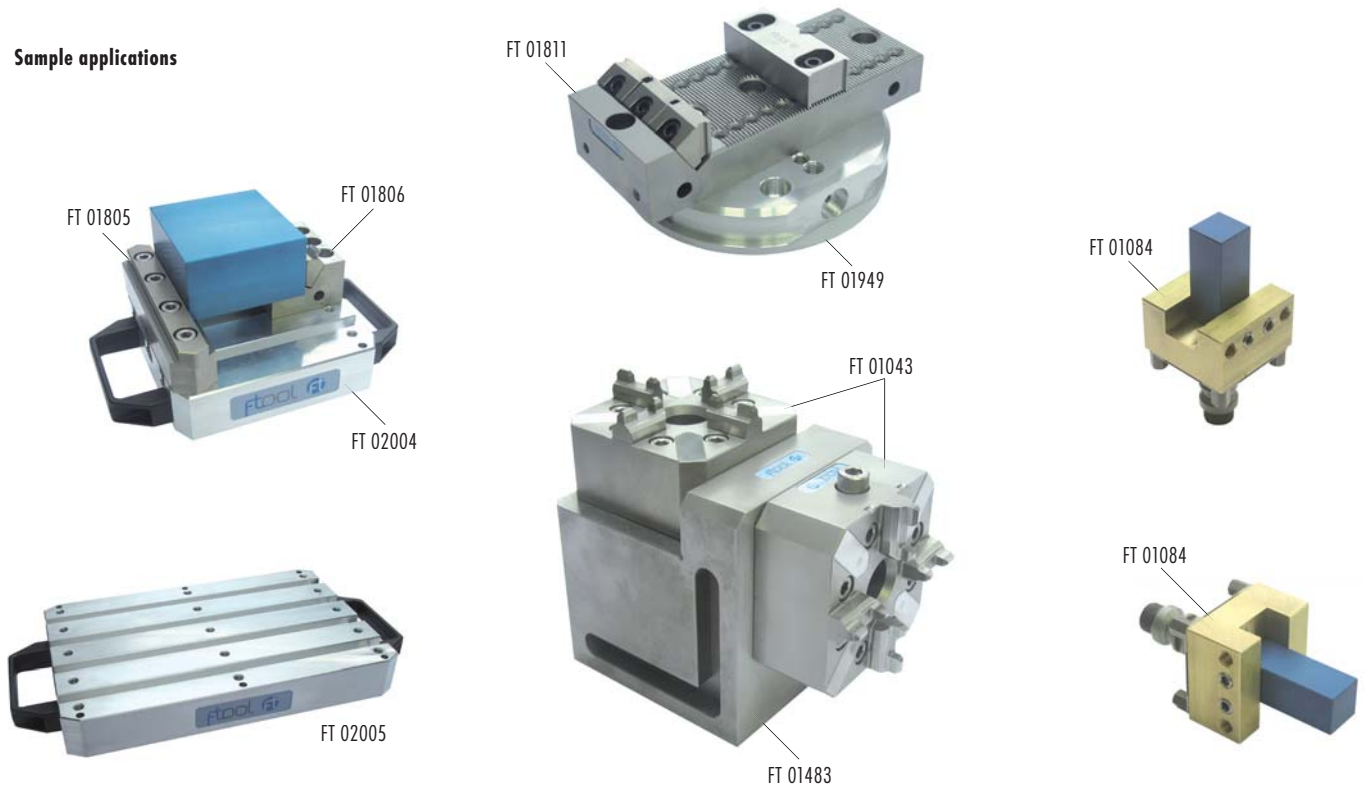

Centering with the F-Tool PowerPlate is suitable for high cutting efficiency

Assembling of the PowerPlate

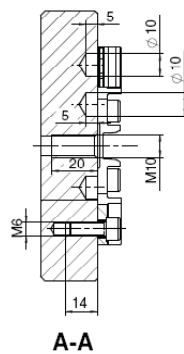
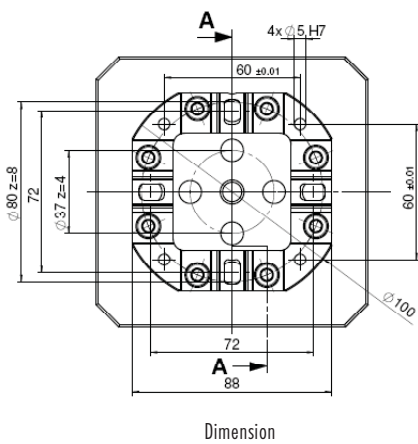

Pin with lateral power intake
Pin for the removal

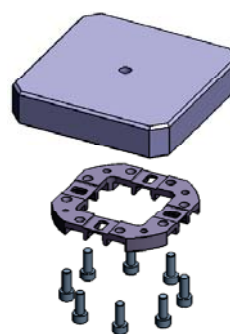
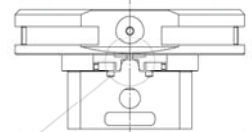
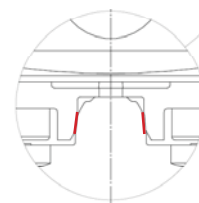

Assembling from the bottom

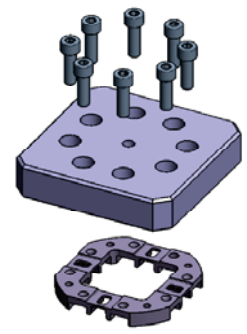

Assembling from above



FT 01811



FT 01074



FT 01949

FT 01835



FT 01483

F-Tool 5S-PowerSet

The 5S-PowerSet is a wide clamping element set, suited for the 5-side machining of work pieces on 3-axis milling machines. The set contains:

- 1 x FT 01483 Square block ER/3R/PIN chuck with 2 x FT 01043 FTool ER chuck 80P
- 1 x FT 01811 FTool PIN MultiClamp 181 x 72 mm B40, corrosion-resistant
- 2 x FT 01949 FTool Pallet PP148 alu (Power Plate)
- 2 x FT 01835 FTool ER-PowerPlate (individual centering plate for pallets and fixtures)
- 4 x FT 01074 Chucking spigot F/M long without flushing

Article no.	Article	Quantity	Weight	Code
FT 02003	FTool 5S-PowerSet	1 Set	18.60 kg	P



ER Chuck 80P

Manual chuck, hardened, stainless steel.

For the system sizes ER 50 and 100. Hole patterns chuck: 8 x M6 TK Ø 61 x 45°

Grinded flanks for the power centering. Strong floating gripping mechanism.

Clamping force by hand with allen key: 8'000 N

Article no.	Article	Quantity	Weight	Code
FT 01043	FTool ER chuck 80P	1 piece	1.60 kg	A



Square block

Accurate ground square block, corrosion-resistant, for the assembling of one or two ER chuck 80P (FT 01043) or 3R chuck 80 (FT 01044), in vertical or horizontal position. For the application with brackets on miscellaneous tooling machines. Spindle height at horizontal installation of the chuck: 75 mm

Article no.	Article	Quantity	Weight	Code
FT 01483	Square block ER/3R/PIN chuck	1 piece	8.20 kg	A



F-Tool ER-PowerPlate

Centering plate with P-profile, compatible with FT 01043 FTool ER chuck 80P plus all EROWA chucks with P-profile, EROWA PowerChuck and EROWA ProductionChuck 210 Combi. Highly friction centering. For the direct assembling on pallets and fixtures.

Article no.	Article	Quantity	Weight	Code
FT 01835	FTool ER-PowerPlate	1 piece	0.27 kg	P



F-Tool Pallet ER-PP148 alu (PowerPlate)

The F-Tool pallet is equipped with the F-Tool PowerPlate and can be used on all EROWA chucks with P centering. For the collet of fixtures and work pieces, the pallet with hole pattern 4 x Ø 9/110 x 50//4 x Ø 9/TK37A) and 4 x M8/D80 is prepared for the assembling of the F-Tool MultiClamp FT 01809 and FT 01811.

Article no.	Article	Quantity	Weight	Code
FT 01949	FTool Pallet PP148 alu (Power Plate)	1 piece	1.41 kg	P



FT 02004



FT 02005



FT 02006

F-Tool T-nut ER-P-Pallet with handles

The F-Tool PP-pallet with handles can be used perfectly on EROWA chucks with P-profile. The T-nut pallet is suited for the collet of work pieces and fixtures. The pallets are equipped with the PowerPlate FT 01835.

Article no.	Article	Quantity	Weight	Code
FT 02004	FTool T-slot PP-Palette 150 x 150mm	1 piece	2.40 kg	P
FT 02005	FTool T-slot PP-Palette 280 x 180mm	1 piece	4.30 kg	P
FT 02006	FTool Universal-PP-Palette 280 x 180mm	1 piece	4.90 kg	P



F-Tool PIN BrassClamp

The F-Tool PIN BrassClamp is a brass retainer with hardened, corrosion-resistant pull-down jaws. If necessary, the stop surface on the holder can be milled to approx. 28 mm. The BrassClamp is supplied as standard with 3 clamping jaws with a clamping range of 0-3 mm. The BrassClamp is suited for use as an electrode (in particular graphite) retainer. However, it can also be used as a precision parts clamp, because the brass jaw can be enlarged precisely.

B40 = prepared for PIN system, 3R adapter plate, T-nuts and grid plate 40 mm/M8. Delivered with screws ITS 50 = equipped with ITS centering plate 50 / EWIS preparation. Delivered with ITS chucking spigot F/A.

Article no.	Article	Quantity	Weight	Code
FT 01807	FTool PIN BrassClamp 72 x 72 mm B40	1 piece	1.85 kg	P
FT 01808	FTool PIN BrassClamp 72 x 72 mm ITS50	1 piece	2.00 kg	P



F-Tool MultiClamp 105

The F-Tool MultiClamp is a precision pull-down clamp with adjustable, hardened pull-down and stop jaws. It is manufactured of hardened, corrosion-resistant steel. The stop jaw can be adjusted in the tooth grid every 2 mm. The support surface has a tolerance of +/- 0.04 mm. Suited as multiple-spanner on T-slot pallet, ITS/UPC pallets and square blocks. The clamping range in total is 48 mm. The clamping range of the flexible jaws is 3 mm H 25 mm.

B40 = prepared for PIN system, 3R adapter plate, T-nuts and grid plate 40 mm/M8. Delivered with screws ITS 50 = equipped with ITS centering plate 50 / EWIS preparation. Delivered with ITS chucking spigots F/A.

Article no.	Article	Quantity	Weight	Code
FT 01809	FTool PIN MultiClamp 105 x 72 mm B40, corrosion-resistant	1 piece	1.90 kg	P
FT 01810	FTool PIN MultiClamp 105 x 72 mm ITS50, corrosion-resistant	1 piece	1.95 kg	P



F-Tool MultiClamp 181

The F-Tool MultiClamp is a precision pull-down clamp with adjustable, hardened pull-down and stop jaws. It is manufactured of hardened, corrosion-resistant steel. Hole grid 40 mm. Suited on T-slot pallet, grid plate, ITS square block or pallet 148 mm. The clamping range in total is 124 mm. The clamping range of the flexible jaws is 3 mm.

Article no.	Article	Quantity	Weight	Code
FT 01811	FTool PIN MultiClamp 181 x 72 mm B40, corrosion-resistant	1 piece	2.94 kg	P

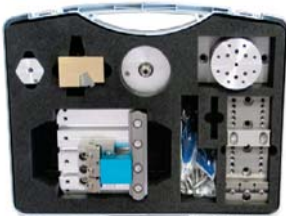

For predominant easy 3D machining the F-Tool PIN tool set can be used in place of the 5S-PowerSets.

F-Tool PIN Tool Set

The PIN Tool Set is especially qualified for demo- and education uses, as well as basic initial equipment.

The set FT 01861 contains:

- | | |
|--|---|
| 1 x FT 01336 Adapter plate 120 x 82 mm ER/3R/PIN chuck | 1 x FT 01811 FTool PIN MultiClamp 181 x 72 mm B40 |
| 1 x FT 01716 FTool PIN center chuck | 1 x FT 01812 FTool PIN fixed stop complete |
| 1 x FT 01719 FTool RefPIN HP-Z with flushing (ground) | 3 x FT 01815 FTool RefPIN set |
| 1 x FT 01725 FTool PIN clamping holder 26 mm | 2 x FT 01818 FTool PIN T-slot screw (set of 2 pieces) |
| 1 x FT 01726 FTool PIN electrode spanner Ø 16 mm | 1 x FT 01865 Flat-grip reversible jaw FG-72-h12 |
| 1 x FT 01727 FTool PIN pallet aluminium Ø 80 mm | 1 x FT 01867 Flat-grip-clamping jaw set FCG24-h12 (set of 3 pieces) |
| 1 x FT 01803 PIN T-slot pallet 150 x 150 x 37.5 mm | 1 x FT 01868 FTool PIN parallel support set 10 mm (set of 2 pieces) |
| 1 x FT 01805 Stopper beam B150 H25 mm | - Miscellaneous screws and allen keys |
| 1 x FT 01806 PIN clamping block 58 x 72 mm complete | |
| 1 x FT 01807 FTool PIN BrassClamp 72 x 72 mm B40 | |

Article no.	Article	Quantity	Weight	Code
FT 01861	FTool PIN Tool Set	1 piece	14.00 kg	C
Options:				
FT 01716	FTool PIN center chuck	1 piece	1.48 kg	P
FT 01727	FTool PIN pallet aluminium Ø 80 mm	1 piece	0.34 kg	P
FT 01815	FTool RefPIN set	1 Set	0.07 kg	P
FT 01483	Square block ER/3R/PIN chuck	1 piece	8.20 kg	A

FT 01727

FT 01815
RefPIN Set

FT 01716

FT 01483